

## Product Description

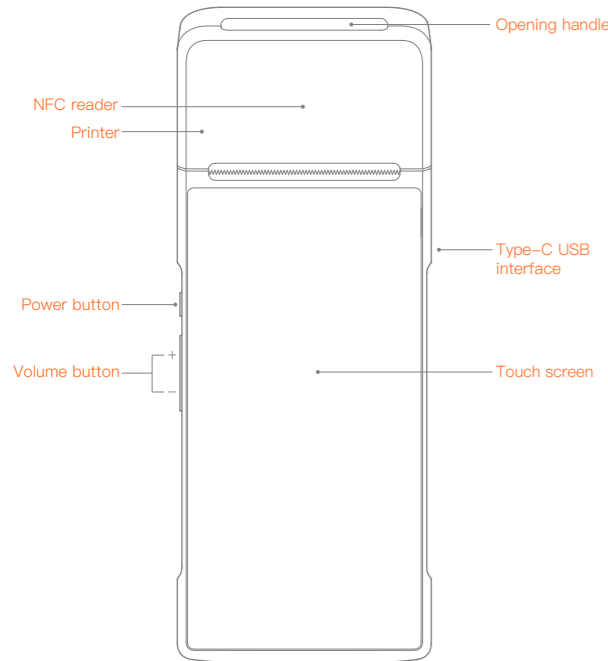

### Power button

Short press: wake up the screen, lock the screen.  
Long press: long press for 2-3 seconds in power off mode to switch on the device.  
Long press for 2-3 seconds in normal operation mode to select power off or reboot.  
Long press for 11 seconds when system is frozen for automatic reboot.

### Volume button

Volume adjustment (with app support, the button can be set as quick code scan button).

### Printer

For printing sales slips in power on mode.

### NFC reader

Be used for NFC cards like loyalty card.

### Type-C interface

For device recharging and developer debugging.

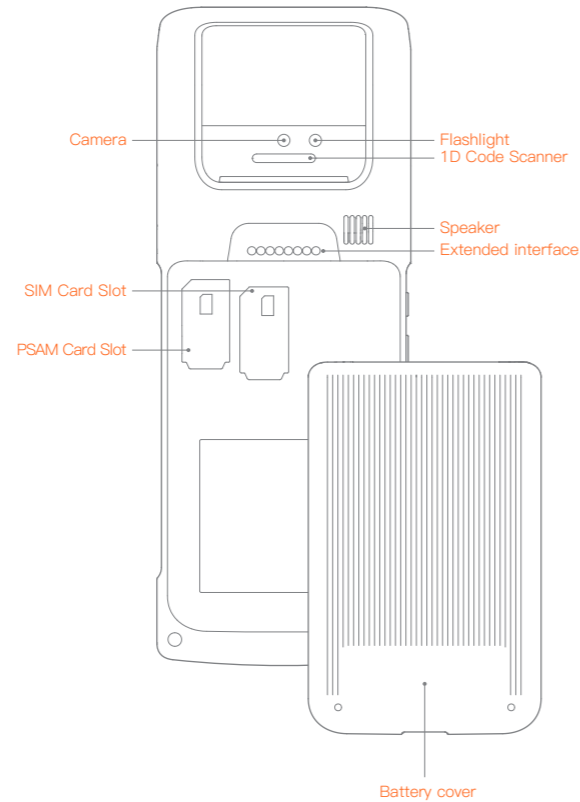

### Camera

Supports photographing and 1D/2D code quick scanning.

### PSAM Card Slot

Used for inserting the PSAM Card.

### SIM Card Slot

Note: To prevent system errors, please make sure the device is turned off when you insert or remove the SIM card.

### 1D Code Scanner

The 1D Code Scanner is used for reading product bar codes and mobile payment code.  
(This Scanner only supports 1D bar codes)

Note: don't look straight at the Infrared scanning head to avoid eye injuries.

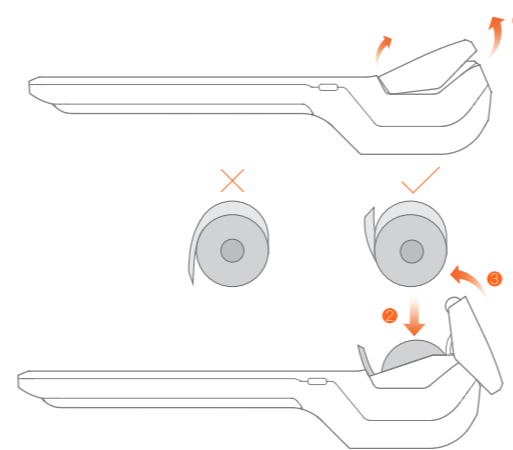

### Printing instructions

This device supports 58mm thermal paper with the specifications of  $57\pm 0.5\text{mm} \times \varnothing 40\text{mm}$

- Please open the paper container with the uncovering handle (as shown in Fig.1). Please do not force open the paper container to avoid print head gear wear;
- Feed the paper correctly into the paper container in the direction as shown, and pull some paper outside the cutter (as shown in Fig.2);
- Close the cover of the paper container to finish printing paper feeding (as shown in Fig.3).

Note: If the printed paper is blank, please check whether the paper roll has been installed in the correct direction.

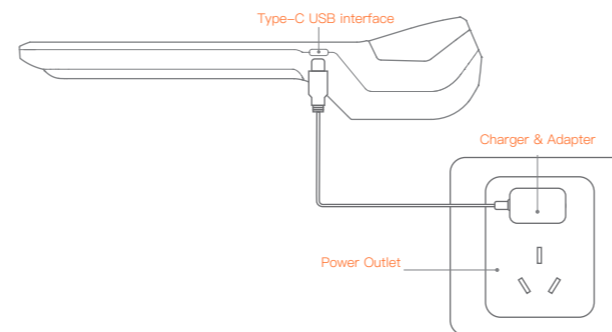

### Instructions for recharging and battery

This device supports charging only by USB cable

- Connect the 5V adapter to the power supply socket;
- Connect the USB cable to the USB interface of the device for recharging;
- The screen will display the recharging icon during the recharging process;
- If the recharging icon does not appear, please check whether the USB interface is well connected.

### Instructions/Notes for battery

- This device adopts 7.6V/2580mAh lithium battery; please do not disassemble the battery.
- In order to protect the battery life, we recommend that you recharge the device whenever possible, and please do not allow the battery to fully drain before recharging.

## Extremely easy settings

Only a few steps to activate an intelligent business device

- Set 2G/3G/4G: when power off, insert the 2G/3G/4G card and then power on. (Refer to the Technical Specifications for the support of cards)
- Long press the Power Key for 2-3s to activate the backlight of screen, and then operate following the prompts after entering the startup/booting screen for the first time. 2 modes for accessing the Internet are available.
- Set WiFi
  - Click "Set" button, activate "WLAN" to enter the WLAN searching screen, and wait it to list all useable WLAN hot spots;
  - Click the WLAN to be connected, and enter the access password in case of an encrypted network.

### Download/use Apps

After connected to the Internet, open the App Market, find, download and install the Apps.

## FAQ

### Booting failure (e.g. low battery)

- Plug the USB cable and charge for 3min;
- Check if the screen displays the normal charging status.

### System crash

- Long press the Power Key for 11s to reboot.

### Read the installed Help App for more information

## Precautions

### Safety Warning

- Connect the AC plug to the AC socket corresponding to the marked input of the power adapter;
- Do not use in the presence of any potentially explosive gas;
- To avoid injury, unauthorized persons shall not open the power adapter;
- This is a Class A product. This product may cause radio interference in living environments. In that case, the user may be required to take adequate measures against interference.
- Battery replacement:
  - Explosion danger may arise if replacing with the wrong battery!
  - The replaced battery shall be disposed of by maintenance personnel, and please do not throw it into fire!

### Significant Safety Instructions

- This terminal is a handheld device, and the user shall protect the password from being peered at by others while entering the password;
- Do not install or use the device during lightning storms to avoid the potential risks of lightning shock;
- Please turn off the power immediately if you notice abnormal odor, heat or smoke;
- The paper cutter is sharp, please do not touch!

### Suggestions

- Do not use the terminal near water or moisture to prevent liquid from falling into the terminal;
- Do not use the terminal in extremely cold or hot environments, such as near flames or lit cigarettes;
- Do not drop, throw or bend the device;
- Use the terminal in a clean and dust-free environment if possible to prevent small items from falling into the terminal;
- Please do not use the terminal near medical equipment without permission.

### Statements

The Company does not assume responsibilities for the following actions:

- Damages caused by use and maintenance without complying with the conditions specified in this guide;
- The Company will not assume any responsibilities for the damages or problems caused by optional items or consumables (rather than the initial products or approved products of the Company). The customer is not entitled to change or modify the product without our consent.
- The product's operating system supports official system updates, but if you change the operating system into a third party ROM system or alter the system files by system cracking, it may cause system instability and security risks and threats.

### Disclaimer

As a result of product upgrading, some details in this document may not match the product, and the actual product shall govern. The Company reserves the right of interpretation of this document. The Company also reserves the right to alter this specification without prior notice.

## Technical specifications

Item	Technical Specifications
Operating system	Android 7.1
CPU basic frequency	1.4GHZ four cores
RAM	1GB LPDDR3
FLASH	8GB Nand Flash
Display	5.99 inch IPS, resolution 1440×720
Touch screen	Capacitive two–touch screen
Camera	500W AF
Wireless data	2G: B2/B3/B5/B8 3G: WCDMA(B1/B2/B4/B5);EVDO(BC0/BC1) 4G: B2/B4/B7/B17/B28
Wi-Fi	Build-in Wi-Fi 802.11a/b/g/n(2.4G/5G)
Bluetooth	Support of bluetooth 3.0/4.2BLE and iBeacon
Keys	Power key, volume key
Interfaces	Configuration interfaces Type–c, SIM, PSAM, support of OTG
Printer type	Thermal Printer
Printing paper specifications	Width 58mm, maximum diameter 40mm
NFC	mifare/ISO 14443 Type A/B/ISO15693
Battery	7.6V/2580mAh
Outline dimensions	L 214mm × W 83mm × H 49mm
Adapter	OUTPUT: DC5V/2A INPUT: AC100~240V/0.3A 50/60Hz
Adapter Model	TPA–23A050200UU01

This device complies with Part 15 of the FCC Rules. Operation is subject to the following two conditions:

(1) This device may not cause harmful interference.

(2) This device must accept any interference received, including interference that may cause undesired operation.

FCC ID:2AH25T5921

NOTE: Changes or modifications not expressly approved by the party responsible for compliance could void the user’s authority to operate the equipment.

NOTE: This equipment has been tested and found to comply with the limits for a Class B digital device, pursuant to Part 15 of the FCC Rules. These limits are designed to provide reasonable protection against harmful interference in a residential installation. This equipment generates uses and can radiate radio frequency energy and, if not installed and used in accordance with the instructions, may cause harmful interference to radio communications. However, there is no guarantee that interference will not occur in a particular installation.

If this equipment does cause harmful interference to radio or television reception, which can be determined by turning the equipment off and on, the user is encouraged to try to correct the interference by one or more of the following measures:

---Reorient or relocate the receiving antenna.

---Increase the separation between the equipment and receiver.

---Connect the equipment into an outlet on a circuit different from that to which the receiver is connected.

---Consult the dealer or an experienced radio/TV technician for help.

Body–worn Operation

This device was tested for typical body–worn operations. To comply With RF exposure requirements, a minimum separation distance of 1.0cm must be maintained between the user’s body and the handset, including the antenna.

Third–party belt–clips, holsters, and similar including the antenna. Third–party belt–clips, holsters, and similar accessories used by this device should not contain any metallic components. Body–worn accessories that do not meet these requirements may not comply with RF exposure requirements and should be avoided.

**Specific Absorption Rate (SAR) information:**

This wireless phone meets the government’s requirements for exposure to radio waves.

The guidelines are based on standards that were developed by independent scientific organizations through periodic and thorough evaluation of scientific studies. The standards include a substantial safety margin designed to assure the safety of all persons regardless of age or health.

FCC RF Exposure Information and Statement. The SAR limit of USA (FCC) is 1.6W/kg averaged over one gram of tissue.

Device types: T5921 has also been tested against this SAR limit. The highest SAR value reported under this standard during product certification when properly worn on the body is 1.218W/kg (1gSAR, test distance:5mm, limit 1.6W/kg), 1.529W/kg(10gSAR, test distance:0mm, limit 4W/kg) and 1.359W/kg(1gSAR, test distance:19mm(power sensor), limit 1.6W/kg). This device was tested for body–worn operations with the back of the handset kept 10mm and 5mm from the body. To maintain compliance with FCC RF exposure requirements, use accessories that maintain a 10mm and 5mm separation distance between the user’s body and the back of the handset. The use of belt clips, holsters and similar accessories should not contain metallic components in its assembly. The use of accessories that do not satisfy these requirements may not comply with FCC RF exposure requirements, and should be avoided.

**Name and content of toxic and harmful substances**

**contained in this product are shown in the following table**

Name of parts	Toxic and harmful substances and elements					
	(Pb)	(Hg)	(Cd)	(Cr(VI))	(PBB)	(PBDE)
Circuit board	×	○	○	○	○	○
Shell	○	○	○	○	○	○

○:It indicates that the content of toxic and harmful substances in all homogeneous materials of this part is below the limit specified in SJ/T11363–2006.

×:It indicates that the content of toxic and harmful substances is higher than the limit specified in SJ/T11363–2006 in at least one homogeneous material of this part; however, the the reason why the toxic substance of that part exceeds the limit is that there is no applicable material to replace it currently.

For products that have reached or passed the service years for environmental protection, they should be recycled according to Measures for Control and Management of Electronic Information Products and should not be thrown away at will.

This product can be used across EU member states.

The full text of the EU declaration DOC is available at the following internet address: www.sunmi.com

**Manufacture**

Shanghai Sunmi Technology Co., Ltd.  
Room 505 No.388 Song Hu Road Shanghai, China

# V2 PRO

## User Guide T5921

### List of packaged items

Terminal device × 1

User’s Guide × 1

Charger & Adapter × 1

USB Cable × 1

\_\_\_\_\_